

Aqua Smarte Plus™ Mineral Dispensing System

Model 7700
For Pools up to 25,000 Gallons



**AQUA
SMARTE
Plus™**

**System Includes the
Aqua Smarte Plus
Mineral Activator™**
Patented Mineral Disinfectant

Customer Service 800-222-0169
www.kingtechnology.com

TABLE OF CONTENTS

Aqua Smarte Plus Introduction	3
Swimming Pool Tips	4
Start-up and Operation	5-6
Replacing Aqua Smarte Plus Mineral Activator	7
Using Aqua Smarte Plus Shine, Optimize, MizerMax Pac	8
Using Aqua Smarte Plus CANNONBALL!	9
Troubleshooting	10
Parts List	11
Replacing Control Dial O-Rings	12
Replacing Cap O-Rings and Knobs	12
Winterizing	13
Above Ground Filter Installation	14
Above Ground Base Installation	15
Warranty	16

For information on King Technology's entire product line, visit our website at www.kingtechnology.com

Aqua Smarte Plus™

Welcome to easier pool care courtesy of Aqua Smarte Plus. With Aqua Smarte Plus, your pool water will look and feel better without a lot of work or a lot of chlorine. This system+ controls bacteria using a combination of minerals and reduced chlorine levels – Chlorine lasts 2X longer with Aqua Smarte Plus Mineral System. There are 3 parts to the Aqua Smarte Plus System: The Above Ground Aqua Smarte Plus Docking Station, the Aqua Smarte Plus Mineral Activator and the Aqua Smarte Plus MizerMax Pac!

Part 1 Aqua Smarte Plus Docking Station™

The water treatment center that controls the flow of water to each part of the Aqua Smarte Plus System.



For Above Ground Pools up to 25,000 gallons.

Part 2 Aqua Smarte Plus Mineral Activator™

Holds the minerals and fits inside the Docking Station.

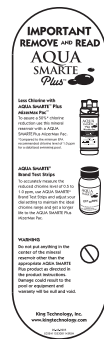

THE AQUA SMARTE PLUS MINERAL ACTIVATOR MUST BE REPLACED EVERY SIX MONTHS OR AFTER ONE POOL SEASON WHICHEVER IS SHORTER.

Part 3 Aqua Smarte Plus MizerMax Pac™

Pre-filled with chlorine tablets and fits inside Aqua Smarte Plus Mineral Activator.



Aqua Smarte Plus Pool Awake!™ Kit

An easy 3-step pool opening program that effectively removes contaminants, prevents algae and sets a chlorine residual with precise dispensing and no touching chemicals!

OPTIMIZE, SHINE AND CANNONBALL!



Aqua Smarte Plus Pool Asleep™ Kit

An easy 2-step pool closing program that effectively removes contaminants and prevents algae all winter with precise dispensing and no touching chemicals!

SHINE AND CANNONBALL!

Aqua Smarte Plus MizerMax Pac along with the Aqua Smarte Plus Pool Awake! and Aqua Smarte Plus Pool Asleep are sold separately.

+Aqua Smarte Plus Mineral System consists of the Aqua Smarte minerals silver chloride and carbonate used in conjunction with 0.5 ppm chlorine. The Aqua Smarte Plus Mineral Activator must be used in conjunction with the Aqua Smarte Plus MizerMax Pac (EPA Reg. No.: 53735-2), an EPA registered chlorine pool product or a chlorine delivery device.

Swimming Pool Tips

Start-up and Yearly Maintenance

1.



Make sure the pool has adequate circulation. The pool water must completely circulate through the pump and filter at least 1 to 2 times per day. This usually requires 8 to 12 hours. Check with your dealer for the proper circulation time for your pool.

2.

Before beginning with any pool care program, you must first balance your pool water. Take a water sample to your local pool professional or use a complete test kit that will test for the following important elements.

Water Balance Guidelines

pH:	7.2 - 7.8
Total Alkalinity:	60 - 120 ppm
Calcium Hardness:	150 - 400
Total Dissolved Solids:	<1500
Stabilizer:	20 - 80 ppm
Free Chlorine:	0.5 - 1.0 ppm

3.

Cu
Mg Fe

If your fill water is high in metals, use a sequestering agent or metal out product at start-up only before using the Aqua Smarte Plus Mineral Activator. See your local dealer for details on using these products and always follow manufacturers directions carefully.

4.



After your pool is up and running smoothly, continue to test your water for pH, total alkalinity and chlorine with Aqua Smarte Brand Test Strips and maintain its balance by adding any necessary adjustment products (see your dealer for details).

5.

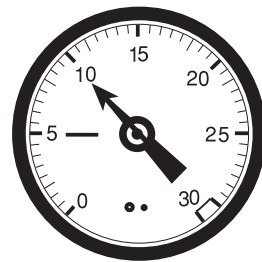

Check the pool's filter gauge often and periodically clean filter per the manufacturer's directions. A dirty filter will slow the flow of water which could hamper proper circulation.

Start-up and Operation - Aqua Smarte Plus Mineral Activator now with 25% greater clarifying power for easier start up.



Add a stabilizer or conditioner to the pool at the beginning of the season if the stabilizer level is below 20 ppm. This will prevent chlorine burn off. Follow manufacturer's directions carefully.

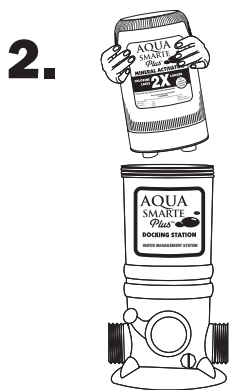

Install Aqua Smarte Plus Mineral Activator into the Aqua Smarte Plus Docking Station. (See page 7 for directions.)

REPLACE THE AQUA SMARTE PLUS MINERAL ACTIVATOR EVERY 6 MONTHS OR AFTER ONE POOL SEASON WHICHEVER IS SHORTER.

Replace cap and run Aqua Smarte Plus Docking Station, with Aqua Smarte Plus Mineral Activator inserted, for 10 minutes at Setting 5.



Shock the pool with Aqua Smarte Plus Shine to rid the water of all contaminants. (see page 8 for directions)



Create a chlorine residual with Aqua Smarte Plus Optimize or a chlorine shock (see page 8 for directions). **THIS STEP IS VERY IMPORTANT TO START-UP.** Always begin with chlorine in the pool water.



For a 90-day algae protection guarantee, insert Aqua Smarte Plus CANNONBALL! into the Aqua Smarte Plus Mineral Activator in the Aqua Smarte Plus Docking Station. (See page 9 for directions.)

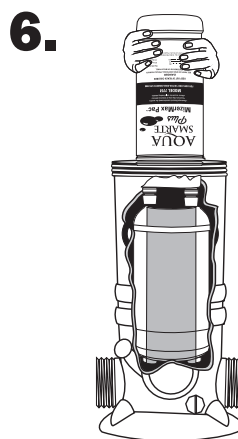

When chlorine reading is down to 1.0 ppm, which may take a few days, insert Aqua Smarte Plus MizerMax Pac. (See page 8 for directions.)



WARNING

If using standard chlorine shocks do not add in or near the skimmer or into the Aqua Smarte Plus Docking Station as it could damage equipment, risk potential explosion or discolor your pool surface.

Start-up and Operation

- 7.** Set control dial by matching up the parameters of your pool on the chart below. THIS IS A STARTING POINT ONLY and may need to be adjusted to fit your individual pool needs. See #8 below for directions. **IMPORTANT:** Pump run times less than 8 hours could result in under chlorination due to inadequate flow through the System.

Above Ground POOL SIZE		8 HOUR PUMP RUN TIME				12 HOUR PUMP RUN TIME				24 HOUR PUMP RUN TIME			
Gallons	Diameter	PUMP SIZE				PUMP SIZE				PUMP SIZE			
		1/2 hp	3/4 hp	1 hp	1 1/2 hp	1/2 hp	3/4 hp	1 hp	1 1/2 hp	1/2 hp	3/4 hp	1 hp	1 1/2 hp
7,000	(18')	5.0	4.5	4.0	3.5	4.5	4.0	3.0	5.0*	3.5	3.0	2.5	4.0*
9,000	(21')	5.5	5.0	4.5	4.0	5.0	4.5	4.0	5.5*	4.0	3.5	3.0	4.5*
12,000	(24')	6.0	5.5	5.0	4.5	5.5	5.0	4.5	4.0	4.5	4.0	3.5	5.0*
15,000		NR	6.0	5.5	5.0	6.0	5.5	5.0	4.5	5.0	4.5	4.0	3.5
20,000		NR	NR	6.0	5.5	NR	6.0	5.5	5.0	5.5	5.0	4.5	4.0

- * – Bypass installation recommended.
NR – This pump size is not recommended for this size pool.

RECOMMENDED FLOW RATE: 20-60 gpm
Most common pool sizes

Find your starting dial setting by matching up the parameters of your pool on the above chart. An above ground pool with approximately 12,000 gallons with a 1 horse pump running 12 hours a day would require a starting setting of 4.5. See example at right.

Above Ground POOL SIZE		8 HOUR PUMP RUN TIME				12 HOUR PUMP RUN TIME			
Gallons	Diameter	PUMP SIZE				PUMP SIZE			
		1/2 hp	3/4 hp	1 hp	1 1/2 hp	1/2 hp	3/4 hp	1 hp	1 1/2 hp
7,000	(18')	5.0	4.5	4.0	3.5	4.5	4.0	3.0	5.0*
9,000	(21')	5.5	5.0	4.5	4.0	5.0	4.5	4.0	5.5*
12,000	(24')	6.0	5.5	5.0	4.5	5.5	5.0	4.5	4.0
15,000		NR	6.0	5.5	5.0	6.0	5.5	5.0	4.5
20,000		NR	NR	6.0	5.5	NR	6.0	5.5	5.0

- 8.** For the first week test the pool water daily for free chlorine with Aqua Smarte Brand Test Strips to ensure correct dial setting. Continue to test weekly throughout the season.



After each testing, adjust the dial up by 1/2 increment if the free chlorine reading has dropped below 0.5 ppm or adjust down by 1/2 increment if the reading has risen above 1.0 ppm. Continue this process each day until the free chlorine reading stabilizes to at least 0.5 ppm.

Remember to adjust dial by 1/2 increments only in order to prevent over chlorination which may bleach pool surfaces.

- 9.** Shock pool every two weeks or as needed to maintain water quality. Follow label directions on the shock treatment used.



WARNING

Do not add shock in or near the skimmer or into the Aqua Smarte Plus Docking Station as it could damage equipment, risk potential explosion or discolor your pool surface.

If using another means of chlorine support, follow steps 1-5 on page 5 then continue below.

6.

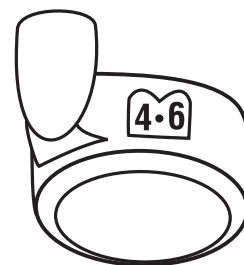

Set dial to Setting 5. Maintain a minimum chlorine reading of 0.5 ppm with a chlorine delivery device or hand feeding.

7.



Shock pool every two weeks or as needed to maintain water quality. Follow label directions on the shock treatment used.



WARNING

Do not add shock in or near the skimmer or into the Aqua Smarte Plus Docking Station as it could damage equipment, risk potential explosion or discolor your pool surface.

Replacing an Aqua Smarte Plus Mineral Activator™

(Aqua Smarte Plus Mineral Activator **MUST** be Replaced Every Season)



1.

Series 7700 (Order #01-13-7712)
NOW FITS THE FOLLOWING SYSTEMS:
 Aqua Smarte Models 5700, 6700 and 7700

Check the top of the box and back label of product to make sure you have the correct Aqua Smarte Plus Mineral Activator to fit your Aqua Smarte Plus Docking Station.

THE AQUA SMARTE PLUS MINERAL ACTIVATOR MUST BE REPLACED EVERY 6 MONTHS OR AFTER ONE POOL SEASON WHICHEVER IS SHORTER.

2.

IMPORTANT REMOVE AND READ
AQUA SMARTE Plus

Less Chlorine with AQUA SMARTE™ Plus MizerMax Pac™
 To obtain a 50%+ chlorine reduction use this mineral activator with an AQUA SMARTE Plus MizerMax Pac.

AQUA SMARTE™ Brand Test Strips
 To accurately measure the reduced chlorine level of 0.5 to 1.0 ppm, use AQUA SMARTE™ Brand Test Strips and adjust your chlorine setting to maintain the ideal chlorine range and get a longer life to the AQUA SMARTE Plus MizerMax Pac.

WARNING
 Do not put anything in the center of the mineral reservoir other than the appropriate AQUA SMARTE Plus product as directed in the product instructions. Damage could result to the pool or equipment and warranty will be null and void.

King Technology, Inc.
www.kingtechnology.com

IMPORTANT: Remove and read the information card.

Please note: Complete instructions for inserting a Aqua Smarte Plus Mineral Activator, and all other Aqua Smarte Plus products are included inside the Aqua Smarte Plus Mineral Activator.

3.



WARNING

Use **ONLY** the factory recommended Aqua Smarte Plus replacement products. **DO NOT USE** bulk chemical tablets in the Aqua Smarte Plus Docking Station or put anything inside the Aqua Smarte Plus Docking Station other than the appropriate Aqua Smarte Plus products as directed in the product instructions. Use of any other product could result in damage to pool equipment or surface, unsafe pool conditions, fire or explosion. Warranty will be VOID if the correct Aqua Smarte Plus products are not used.

4.

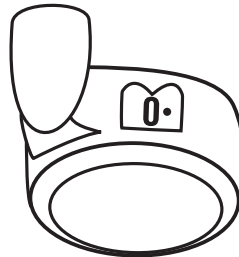

Turn off pump and turn dial to Setting 0. This reduces the flow of water into the unit when the cap is open.

5.



Open cap. Stand back to avoid inhaling chlorine fumes from the the Aqua Smarte Plus MizerMax Pac.

6.

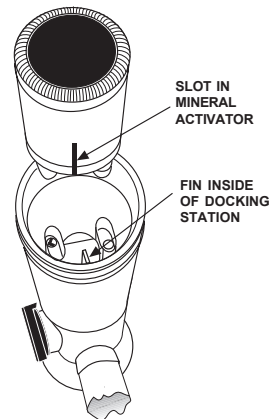

Find slot on side of the Aqua Smarte Plus Mineral Activator and line up with fin inside the Aqua Smarte Plus Docking Station. Lower the Aqua Smarte Plus Mineral Activator into the Aqua Smarte Plus Docking Station until secure.

7.

Mark your calendar for the six month replacement of the Aqua Smarte Plus Mineral Activator. **Once wetted, the time-released mineral coating of this product is effective up to 6 consecutive months or one pool season whichever is shorter. After that time even if you hear the spent media inside it is no longer effective and must be replaced.**

Replacing Aqua Smarte Plus Shine™, Aqua Smarte Plus Optimize™ or Aqua Smarte Plus MizerMax™ Pac



Aqua Smarte Plus Shine



Aqua Smarte Plus Optimize



Aqua Smarte Plus MizerMax Pac



WARNING

Avoid sparks, open flame or smoking when handling Aqua Smarte Plus Shine, Aqua Smarte Plus Optimize or Aqua Smarte MizerMax Pac.

Aqua Smarte Plus Shine is a one time start-up product used to rid the water of all contaminants. Aqua Smarte Plus Optimize - also used at start up, sets the chlorine residual to help find the proper dial setting for maintaining up to 50%* less chlorine while using the Aqua Smarte Plus MizerMax Pacs (EPA Reg. No.: 53735-2). All three products sold separately.

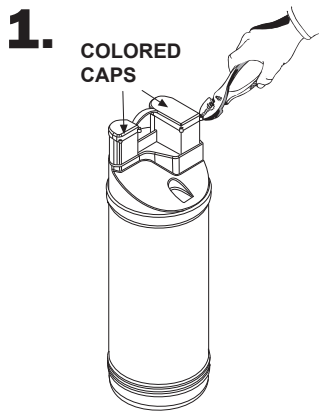

1. To remove colored caps, grab onto the lip of one cap with a pliers and pull up until cap releases. Repeat the process for the other cap.



2. Turn pac over and shake slightly until ingredients fall into tower areas.

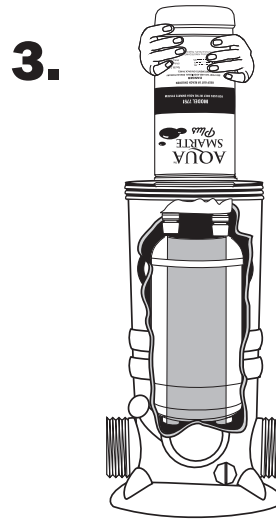

3. Line up the small leg of the pac with the small opening in the Aqua Smarte Plus Mineral Activator and the large leg with the large opening. Lower pac into the Aqua Smarte Plus Mineral Activator until secure.

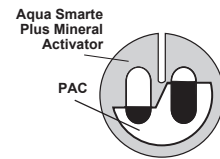

4. Replace cap by hand only. **DO NOT OVER TIGHTEN.**

5. Run the pump and filter for each pac according to the directions on the product label. Remove from the Aqua Smarte Plus Docking Station when empty and discard or offer for recycling.

Using Aqua Smarte Plus CANNONBALL! for an 90-Day Algae Protection Guarantee

If you are not using a Aqua Smarte Plus CANNONBALL! proceed to inserting Aqua Smarte Plus MizerMax Pac. See Aqua Smarte Plus CANNONBALL! product labeling for complete directions for use (EPA Reg. No. 53735-9).

For a preventive dose add:

- One CANNONBALL! Pac for pools up to 15,000 gallons.
- Two CANNONBALL! Pacs for pools between 15,000 and 30,000 gallons.

***NOTE:** Wait 24 hours after shocking before using this product. Avoid using other chemicals until this product has been circulated (filtered) for at least 24 hours.



Remove cap from the Aqua Smarte Plus CANNONBALL! without removing seal.

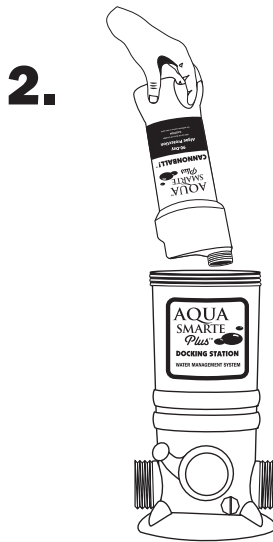

Insert upside down into center of Aqua Smarte Plus Mineral Activator pushing down firmly on key to puncture seal.

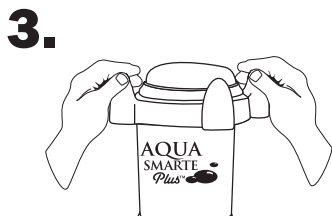

Replace cap by hand only. **DO NOT OVER TIGHTEN.**

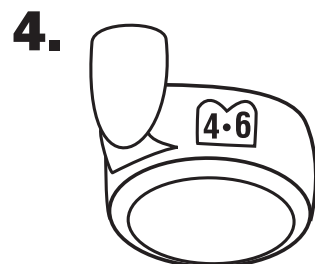

Turn control dial on Docking Station to Setting 5.

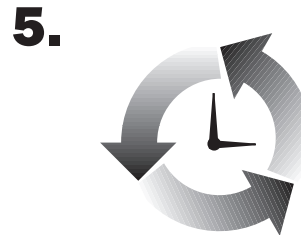

Turn pump on for 90 minutes allowing Aqua Smarte Plus CANNONBALL! to circulate through pool.

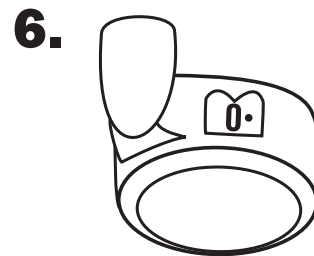

To remove Aqua Smarte Plus CANNONBALL!, turn pump off. Turn dial to Setting 0.

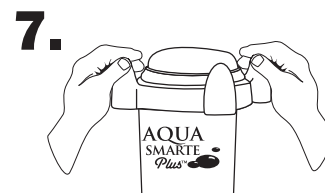

Remove Aqua Smarte Plus Docking Station cap.

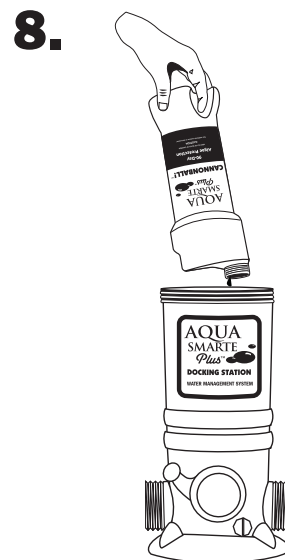

Lift Aqua Smarte Plus CANNONBALL! up and allow any water in the container to drain through the Aqua Smarte Plus Docking Station before discarding in trash.

NOTE: If water shows more than a hint of blue inside the Aqua Smarte Plus Docking Station, replace the Aqua Smarte Plus Docking Station cap, turn dial to Setting 5 and run the pump for one minute.

14a. If pool size requires additional Aqua Smarte Plus CANNONBALL!, repeat steps 1-8.

14b. When water is clear in the Aqua Smarte Plus Docking Station, proceed to inserting the Aqua Smarte Plus MizerMax Pac.

Troubleshooting

For more in-depth troubleshooting, go to www.kingtechnology.com

Problem	Remedy		
<p>1. What do I do if the water looks cloudy?</p>	<p>1. Make sure your filtration system is working properly (i.e. clean filter, skimmer and pump basket).</p> <p>2. Make sure circulation time is adequate – increase pump</p>	<p>time if not.</p> <p>3. Make sure the pool is properly balanced (see page 4).</p> <p>4. Shock the water to eliminate build up of any organic matter.</p>	<p>5. Make sure pool has a free chlorine reading of 0.5 to 1.0 ppm.</p> <p>6. Check with your dealer for more information.</p>
<p>2. What do I do if the water turns color?</p>	<p>1. Metals in the fill water may have been oxidized. Have the pool tested. Shock the pool and clean the filter until water clarity returns.</p>	<p>2. Algae may be trying to form – shock the pool, increase circulation time if needed and clean the filter.</p>	<p>3. Check with your dealer for more information.</p>
<p>3. What do I do if algae forms in or on my pool?</p>	<p>1. Use a nonmetallic (polyquat) algaecide per the directions on the bottle and brush the sides of the pool often.</p>	<p>2. Clean the filter and shock the pool with chlorine daily until water clarity returns.</p>	<p>3. Check with your dealer for more information.</p>
<p>4. What do I do if I am under chlorinating with the Aqua Smarte Plus MizerMax Pac?</p>	<p>1. If you are unable to maintain 0.5 to 1.0 ppm, first make sure there are chlorine tablets in the tower areas of the Aqua Smarte Plus MizerMax Pac and it is installed properly. If a correction was made, test the water in 24 hours.</p> <p>2. If still low, turn the dial up one setting and test the water again in 24 hours. Continue raising the setting</p>	<p>by one increment each day until the proper reading is achieved.</p> <p>3. Shock the pool if the reading has been lower than 0.5 ppm for more than one day.</p> <p>4. Make sure pump run time is at least 6 hours on high speed (40 gpm or higher) or if not, bleed the air from the back knob each time cap is open.</p>	<p>5. Contact your dealer to have your back pressure tested to ensure it is at least 4 psi.</p> <p>6. Check for a suction side leak by looking for air bubbles in your pump basket or at the return jet. Contact dealer for help in correcting this situation.</p> <p>7. Contact King Technology's Customer Service Department at 800-222-0169.</p>
<p>5. What do I do if I am over chlorinating with the Aqua Smarte Plus MizerMax Pac?</p>	<p>1. If the chlorine reading is over 3.0 ppm, remove the Aqua Smarte Plus MizerMax Pac from the Aqua Smarte Plus Mineral Activator and test the water daily until the reading is down to 1.0 ppm.</p> <p>2. Reinsert the Aqua Smarte Plus MizerMax Pac, lower the dial one setting and test the water again in 24 hours. If the reading has risen, lower the dial one setting again. Continue this process until</p>	<p>proper reading is achieved.</p> <p>3. If over-chlorinating at the lowest possible setting, consider decreasing the circulation time. Depending on your pump size, you may be circulating the water more than is necessary.</p> <p>4. Contact your dealer to have your back pressure tested. If over 8 psi consider a larger eye-ball fitting in the return jet.</p>	<p>5. Check to see if the pressure relief valve is loose or missing and replace. It is a clear plastic piece approximately 1" long installed inside near the base. If loose or missing, it can provide another avenue for water to reach the chlorine.</p> <p>6. Contact King Technology's Customer Service Department at 800-222-0169.</p>

Parts List Model 7700

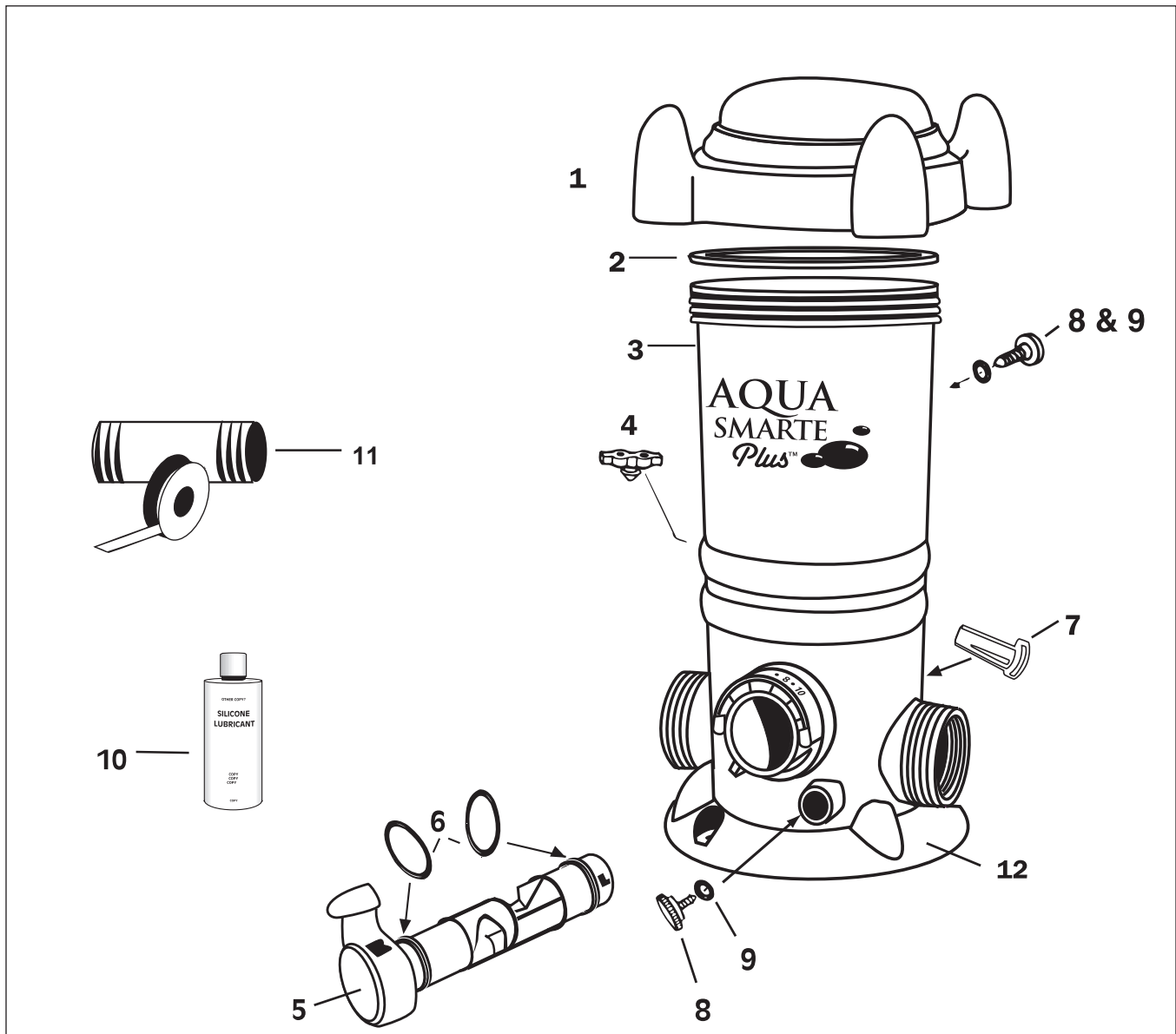

Included with Aqua Smarte Plus Docking Station 7700

REF. #	DESCRIPTION	QTY. INCLUDED
1 & 2	Cap w/O-Ring	1
3	Body	1
4	Pressure Relief Valve	1
5, 6, 7	Control Dial with O-Rings and Locking Pin	1
8 & 9	Knob with O-Ring	2
10	Silicone Lubricant	1
11	Nipple Kit	1
12	Mounting Base	1

Replacement parts for Aqua Smarte Plus Docking Station 7700

REF. #	PART NO.	DESCRIPTION
1 & 2	01-22-1418	Cap w/O-Ring
2	01-22-1920	Cap O-Ring
4	01-22-9480	Pressure Relief Valve
5, 6, 7	01-22-1443	Control Dial with O-Rings and Locking Pin
6	01-22-1450	Control Dial O-Ring Set
8 & 9	01-22-9940	Knob with O-Ring
10	01-22-9971	Silicone Lubricant
11	01-22-1710	Nipple Kit
12	01-22-1485	Mounting Base

Aqua Smarte Plus Docking Station Maintenance

Replacing the Control Dial O-Rings

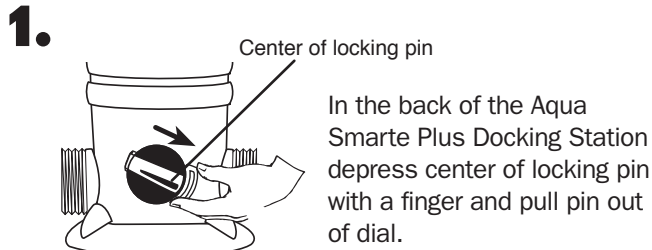

Replacing Cap O-Ring

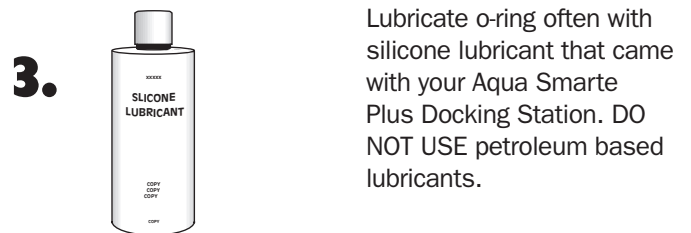
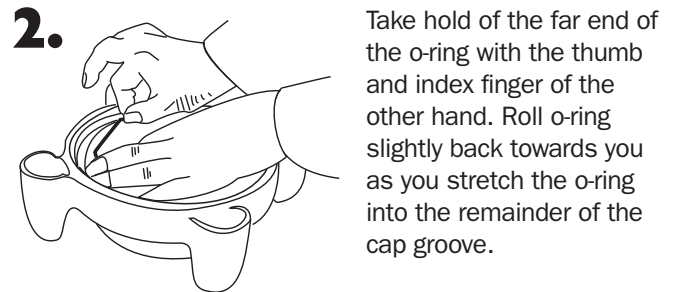
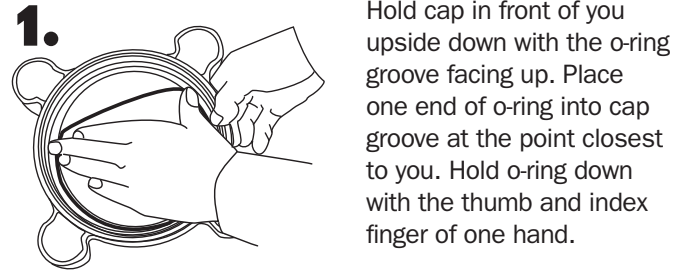

Replacing Knobs

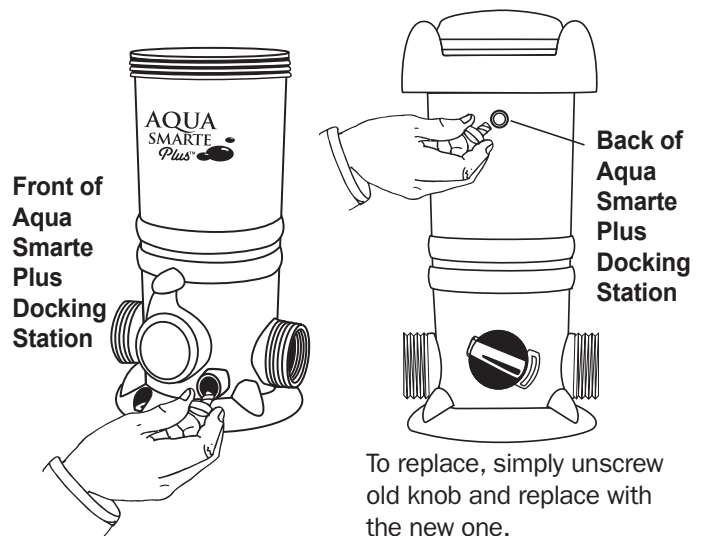

Winterizing

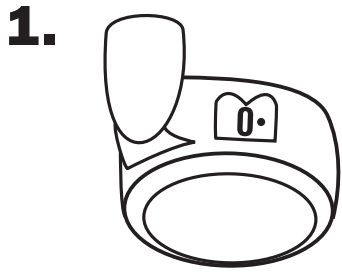

Turn pump off and turn dial to Setting 0.

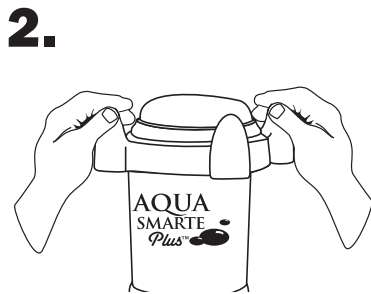

Remove cap.

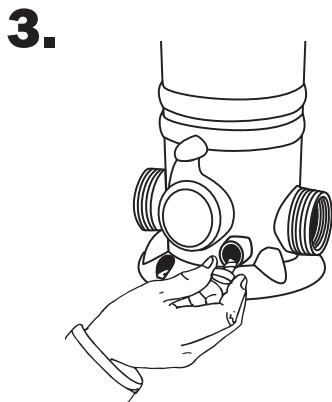

Unscrew knob from the front of Aqua Smarte Plus Docking Station. Allow all water to drain.



If Aqua Smarte Plus MizerMax Pac still contains chlorine, wrap in plastic bag and store in shed or cool well-ventilated location away from children, pets, cars, motorcycles or anything metal that can rust, pit, etc. Make sure Aqua Smarte Plus MizerMax Pac is away from open flame.

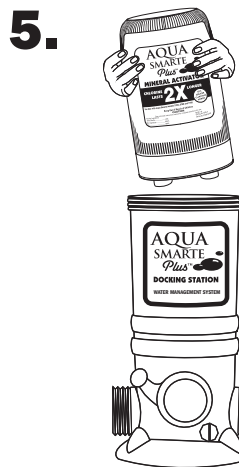

Remove the Aqua Smarte Plus Mineral Activator and discard in trash. Even if you hear spent minerals inside, it is no longer effective.

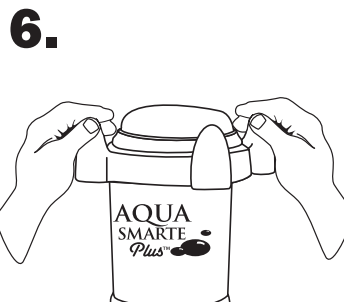

Replace the cap and knob loosely.

TOOLS NEEDED

Screwdriver



Pipe Wrench

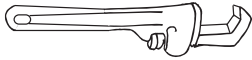

INCLUDED WITH Aqua Smarte Plus Docking Station

Pipe Thread Tape or Sealant



One 6" X 1 1/2" TBE PVC Nipple

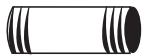

MATERIALS NEEDED

One Hose Adapter
1 1/2" X 1 1/2" X 1 1/4"

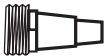

One Section of
1 1/2" Flex Hose
(provided with filter)



One
Hose Clamp



RECOMMENDED

Corrosion Resistant
Check Valve

Above Ground, Filter Installation

1. Apply pipe thread tape or sealant to each threaded end of nipple.

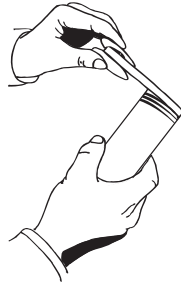

2. Screw one end of nipple into the filter return. Tighten turning 1 to 2 revolutions with wrench. **DO NOT OVER TIGHTEN.**

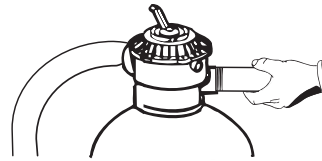

3. Screw either side of the Aqua Smarte Plus Docking Station on to open nipple end until upright and secure.

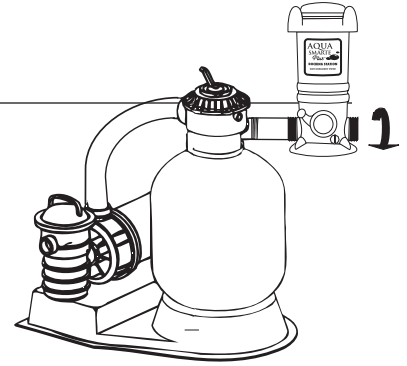

4. Apply pipe thread tape or sealant to threaded end of hose adapter.

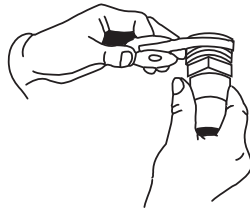

5. Screw adapter into the other side of the Aqua Smarte Plus Docking Station. Hand tighten. Finish tightening by turning 1 to 2 revolutions with wrench. **DO NOT OVER TIGHTEN.**

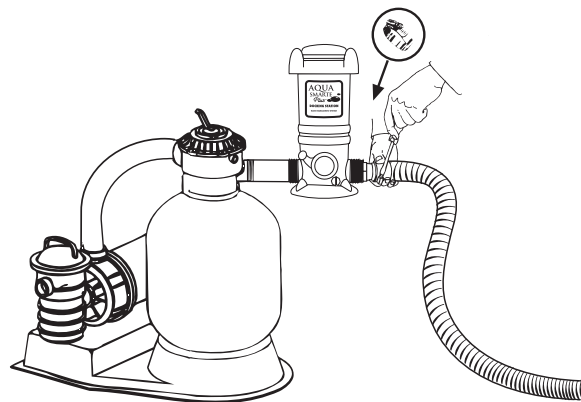
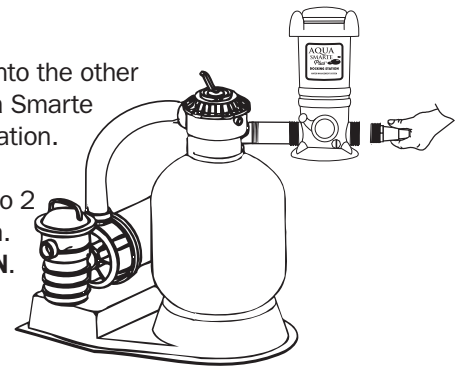
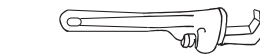

6. Attach return section of hose to the adapter with clamp. Tighten clamp with screwdriver.

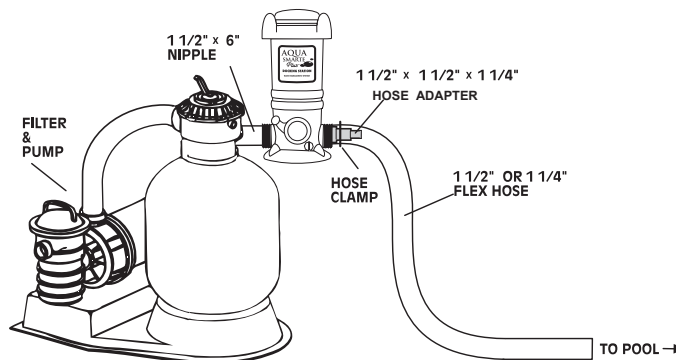

7. If using a Aqua Smarte Plus MizerMax Pac, installing a corrosion resistant check valve is recommended.

TOOLS NEEDED

Screwdriver



Pipe Wrench

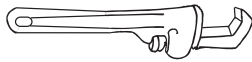

Materials Needed

Pipe Thread Tape or Sealant



One 6" X 1 1/2" TBE PVC Nipple

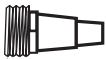

Two Sections of 1 1/2" Flex Hose (one provided with filter)



Two Hose Clamps



Recommended

Corrosion Resistant Check Valve

10 X 1 1/4" Phillips Pan Head Screws with Washers



Option

1 1/2" Male Adapter (slip x MPT)



or

2" Female Adapter (slip x FPT)



When installing with hard PVC pipe, use either a female adapter on the outside port threads or a male adapter on the inside port threads.

Above Ground, Base Installation

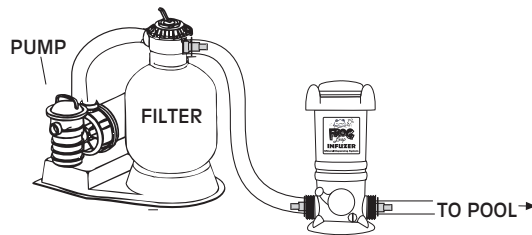

The Aqua Smarte Plus Docking Station should always be installed between the filter and pool (or between heater and pool if applicable).



WARNING

- Never install Aqua Smarte Plus before the heater.
- Any additional sanitizing equipment that is installed with Aqua Smarte Plus must be installed after Aqua Smarte Plus (never before) on the return line to the pool.

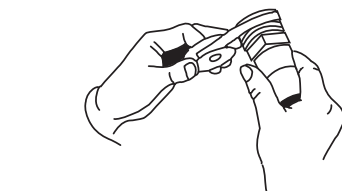

1. Apply pipe thread tape or sealant to the threaded end of both hose adapters.

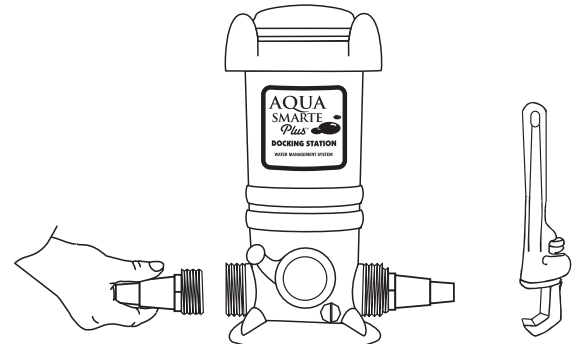

2. Screw adapters into each end of the Aqua Smarte Plus Docking Station. Hand tighten. Finish tightening by turning 1 to 2 revolutions with wrench. **DO NOT OVER TIGHTEN.**

3. Attach the filter section of flex hose to one hose adapter and the return section of flex hose to the other hose adapter with clamps and tighten with screwdriver. Bi-flow valve design allows water flow in either direction.

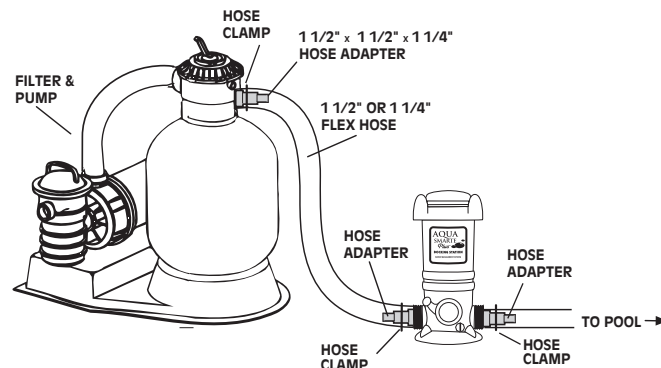
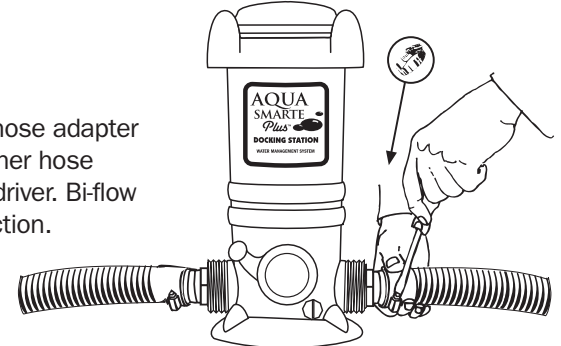

4. If using a Aqua Smarte Plus MizerMax Pac installing a corrosion resistant check valve is recommended.

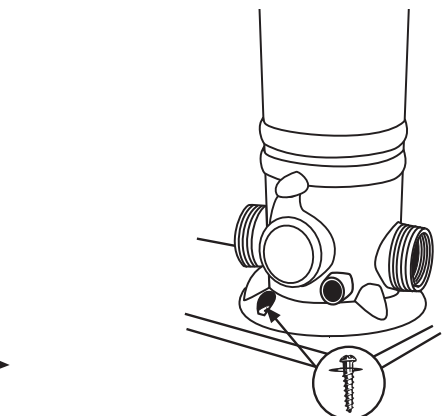

5. For better stability, Aqua Smarte Plus Docking Station may be mounted on a base using Phillips pan head screws. One in front and two in back.

Aqua Smarte Plus™ Docking Station™ Two-Year Limited Warranty

King Technology, Inc. warrants to the original purchaser this unit will be free from any defects in workmanship and/or material, for a period of two (2) years from the date of original purchase. This warranty covers body, cap and control dial, but specifically excludes o-rings. King Technology at its option may replace any defective parts or the entire unit without charge after it is determined what is needed to correct any deficiency. Replacement parts with the exception of o-rings are warranted for the remainder of the original warranty. To extend the limited warranty from two years to ten years, simply complete the warranty card that came with your unit and return it to King Technology within 30 days of purchase and installation.

1. To obtain warranty service, you must deliver the unit to King Technology or its nearest authorized dealer. Shipping expenses are the purchaser's responsibility. The name of the nearest authorized dealer can be obtained by writing or calling King Technology at the address and telephone number provided below. Proof of purchase is required when requesting warranty service. Purchaser must present the sales receipt or other documentation verifying proof of purchase.

2. This warranty does not cover defects caused by: Modification, alteration, repair or service of the unit contrary to the accompanying instructions; physical abuse to or misuse of the product or operation or installation in a manner contrary to the accompanying instructions. This warranty also excludes all costs arising from the installation, adjustment, removal or replacement of defective units or parts. This warranty also excludes any and all claims arising out of the chemicals used in the product or their characteristics.

3. CAUTION - Read carefully – Failure to follow these instructions will void the warranty. Do not add shock in or near skimmer.

A. This unit is not designed for shock treatment of pools. See your pool dealer or distributor for further information concerning shock treatments.

B. Control dial settings higher than needed can result in excess sanitizers being discharged into the pool. If the sanitizer level goes unmonitored, it can result in bleaching or discoloration of areas around the pool inlet or in some cases bleaching or discoloration of the entire pool liner or paint.

C. Excess trichlor in the pool can create health hazards to bathers. Consult each chemical manufacturer's warnings and cautions for specifics.

D. Misuse or failure to use the proper Aqua Smarte Plus Mineral Activator and Aqua Smarte Plus MizerMax Pac may cause damage to equipment or personal injury. This warranty will be null and void, if this unit is not used with the recommended Aqua Smarte Plus Mineral Activator and Aqua Smarte Plus MizerMax Pac.

4. This warranty is the exclusive warranty for the Aqua Smarte Plus Docking Station. This warranty is not transferable. **KING TECHNOLOGY MAKES NO REPRESENTATION OR WARRANTY OF ANY KIND, EXPRESS OR IMPLIED, AS TO MERCHANTABILITY, FITNESS FOR A PARTICULAR PURPOSE OR ANY OTHER MATTER CONCERNING THE AQUA SMARTE PLUS DOCKING STATION.** Any express warranty not provided herein, and any remedy for breach of contract but which for this provision might arise by implication or operation of law is hereby excluded and disclaimed. THE EXCLUSIVE REMEDY FOR ANY CUSTOMER IS THE REPAIR OR REPLACEMENT OF THE UNIT, AND THE RECOVERY OF DAMAGES WILL NOT EXCEED THE PURCHASE PRICE OF THE UNIT. IN NO EVENT WILL KING TECHNOLOGY BE LIABLE FOR ANY INCIDENTAL, CONSEQUENTIAL, SPECIAL OR PUNITIVE DAMAGES FROM ANY CAUSE.

5. Under no circumstance shall King Technology be liable to purchaser or any other person for any damage or loss incurred because of any chemicals used in the product or their physical characteristics, or interruption of service of the product, or any resulting special, incidental or consequential damages or losses. Some states do not allow the exclusion or limitation of incidental consequential damages, so the above limitation or exclusion may not apply to you.

Manufactured by: KING TECHNOLOGY, INC.

530 11th Avenue South, Hopkins, MN 55343 U.S.A.
952-933-6118 • 800-222-0169 • FAX 952-933-2206
www.kingtechnology.com

Made in U.S.A.

U.S. Patents D540,906; D551,971; 6,190,547; 6,210,566; 6,217,892; 6,383,507; 6,544,415; 6,551,609; 6,652,871; 7,604,018 and other U.S. and Foreign patents pending.

